



WEST CRAIGS SOUTH, GLASGOW ROAD, EDINBURGH



TURNHOUSE GOLF COURSE

HSG 20 - CAMMO

EAST CRAIGS

A902 MAYBURY ROAD

TURNHOUSE ROAD

WEST CRAIGS INDUSTRIAL ESTATE

HSG 19 - WEST CRAIGS

WEST CRAIGS

EDINBURGH AIRPORT – CROSSWINDS DEVELOPMENT SITE

EAST COAST RAIL LINE

EDINBURGH GATEWAY

TRAM DEPOT

GYLE SHOPPING CENTRE

GOGAR ROUNDABOUT

TRAM LINE

APPLICATION SITE

A8 GLASGOW ROAD

EDINBURGH PARK

GOGAR KIRK

A702 EDINBURGH CITY BYPASS

GOGARBURN TRAM HALT

RBS HQ

Site Location Plan

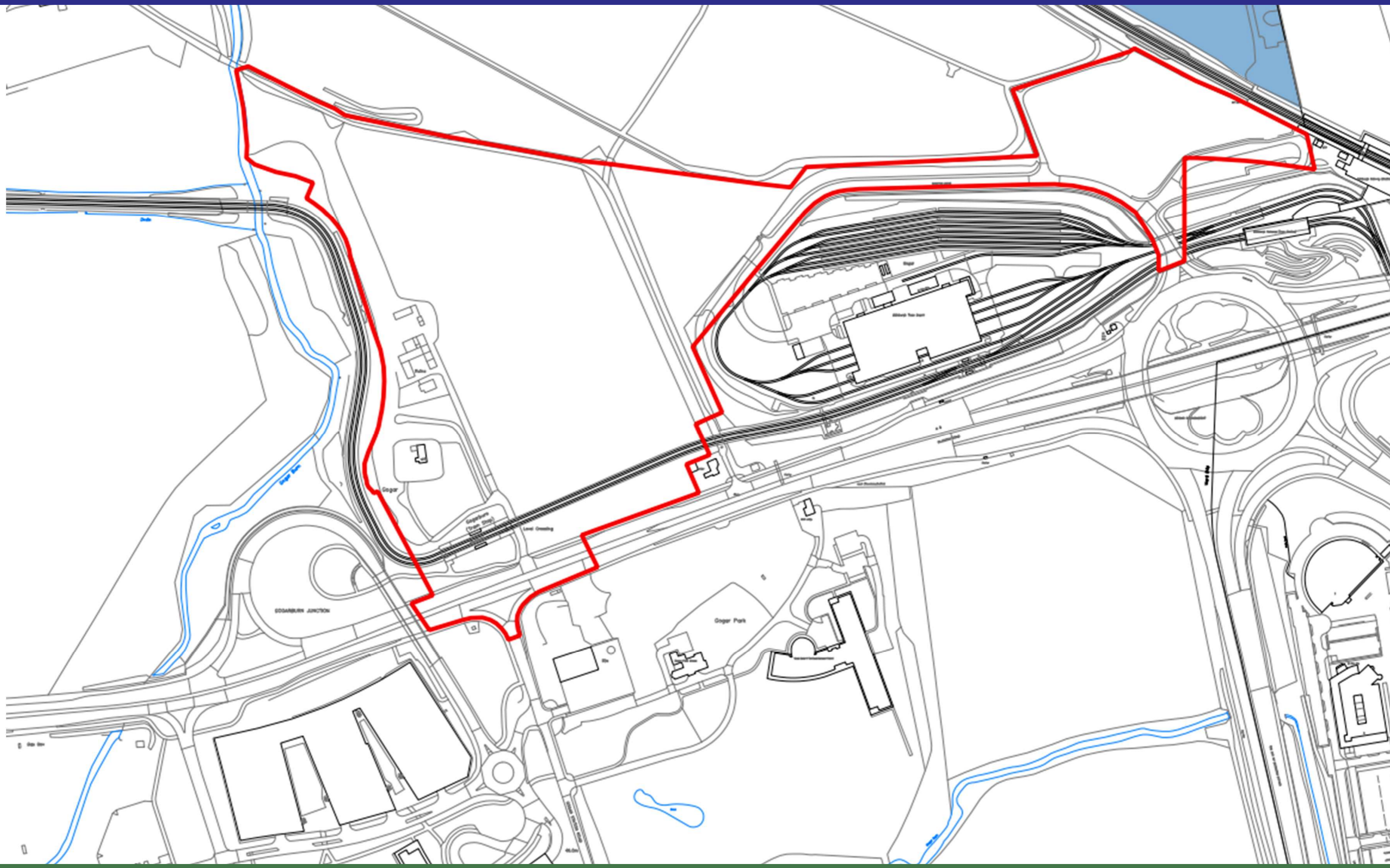

Planning Policy

Development of the West Craigs South site is supported in planning policy terms by the South East Scotland Strategic Development Plan (2013) ('SESplan'), and the Edinburgh Local Development Plan (2016) ('LDP').

Within the SESplan, the site falls within the wider West Edinburgh Strategic Development Area, which is identified for future growth and development.

Within the Local Development Plan, the site falls within the wider 'International Business Gateway' development allocation (Policy EMP 6), which supports in principle housing as a component of business-led mixed use development.

The Local Development Plan also identifies the proposed alignment of a new Gogar Link Road (Transport Proposal T9). Part of this new proposed road travels through the site. This road alignment has been incorporated into the overall masterplan for the proposed development.

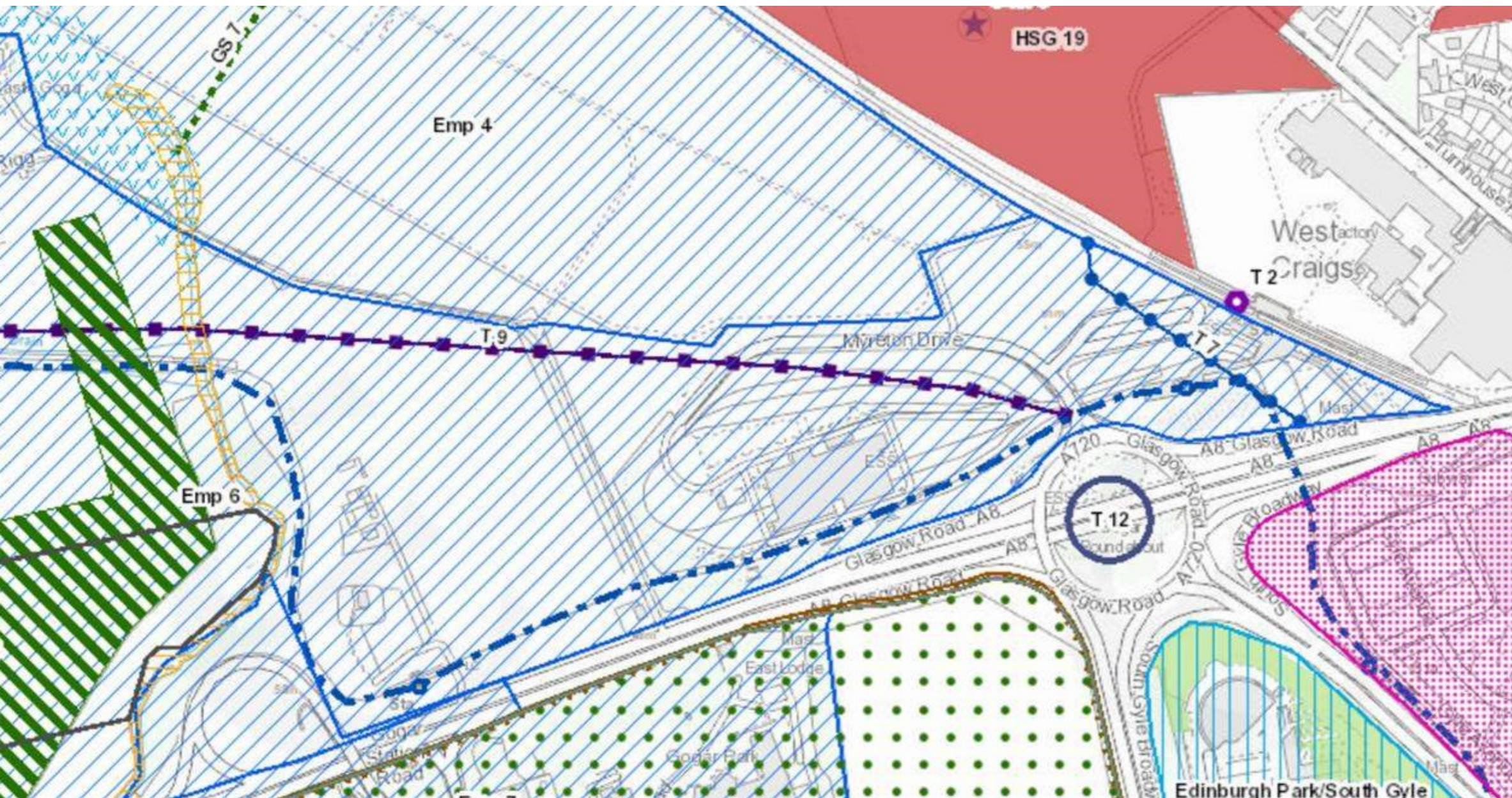

Extract from the Local Development Plan - Proposals Map

Future Development





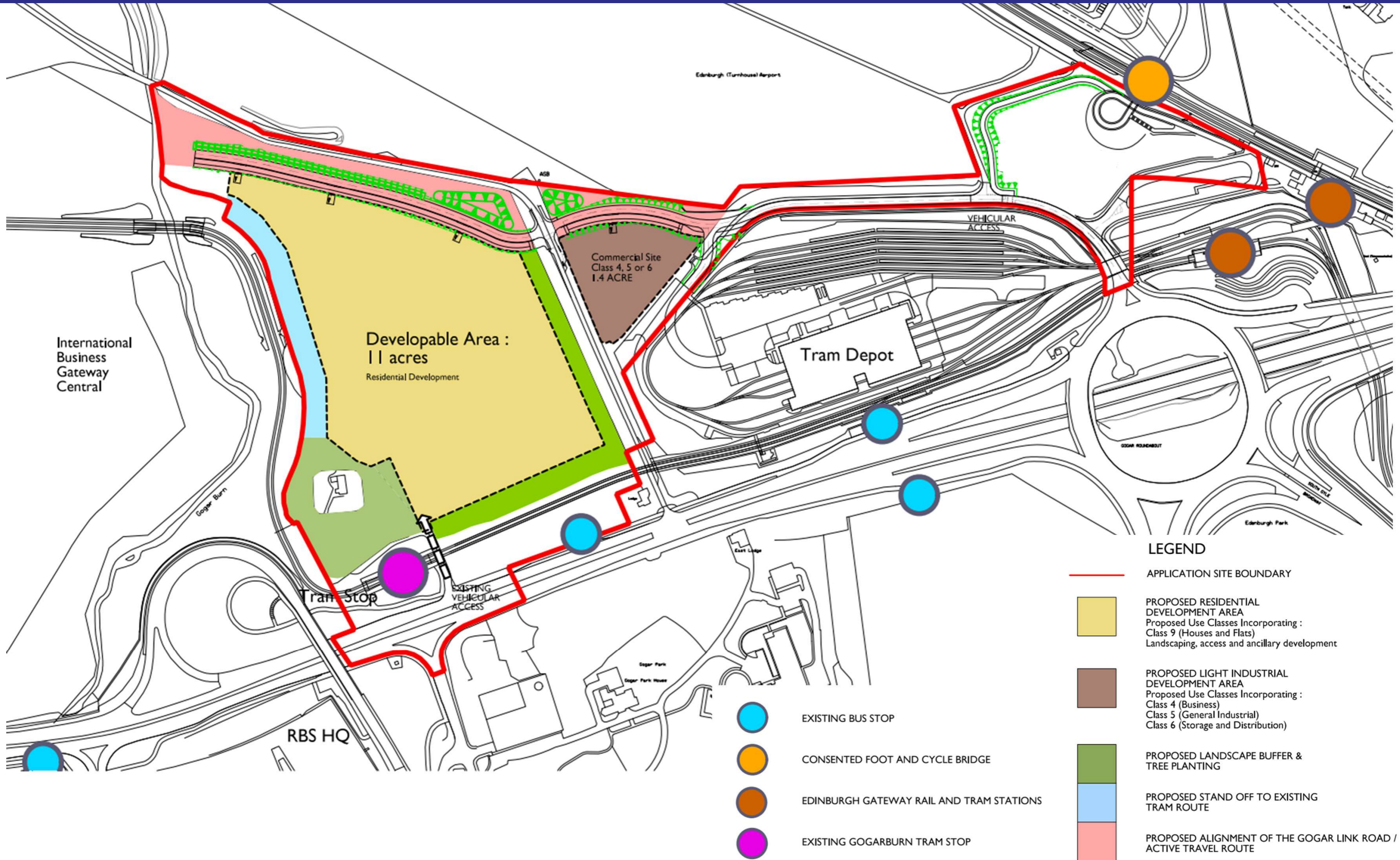

Aerial Photograph Showing Future Development of Adjoining Land

Draft Masterplan

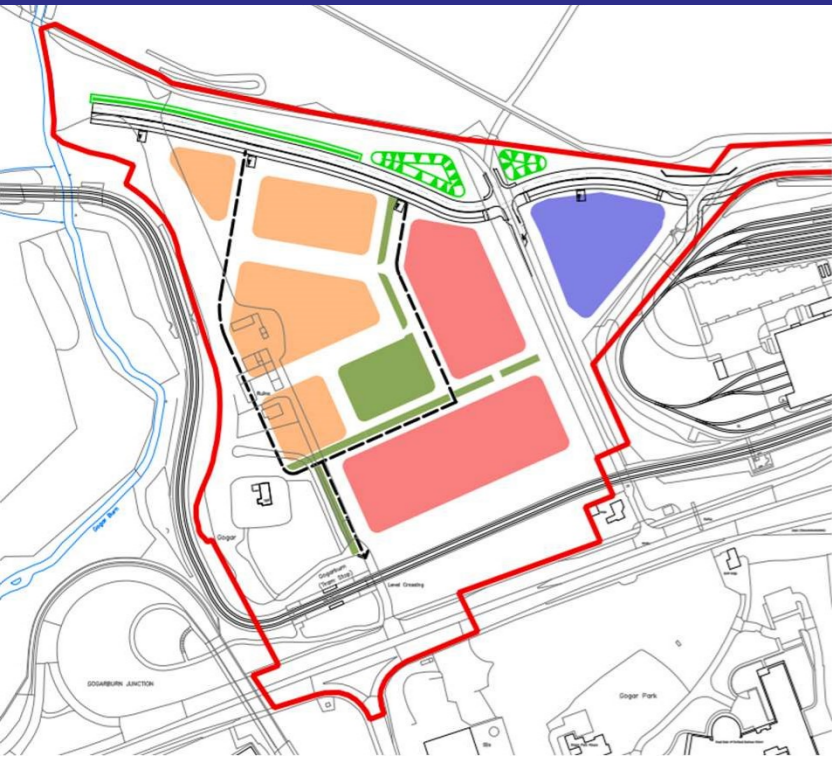

Draft Masterplan



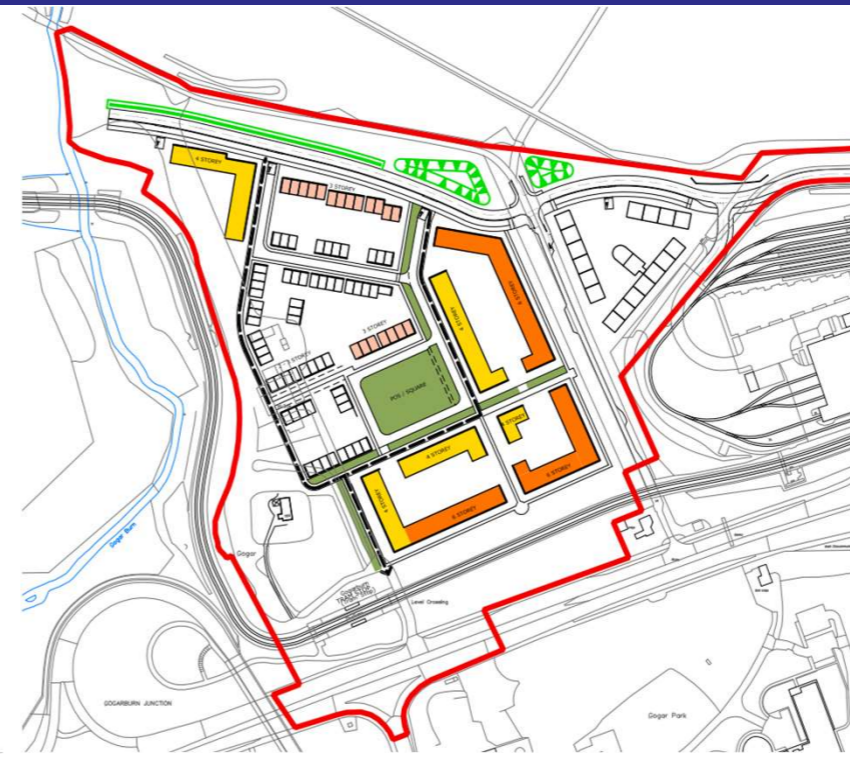

-  HIGHER DENSITY DEVELOPMENT
-  MEDIUM - HIGH DENSITY DEVELOPMENT
-  COMMERCIAL DEVELOPMENT

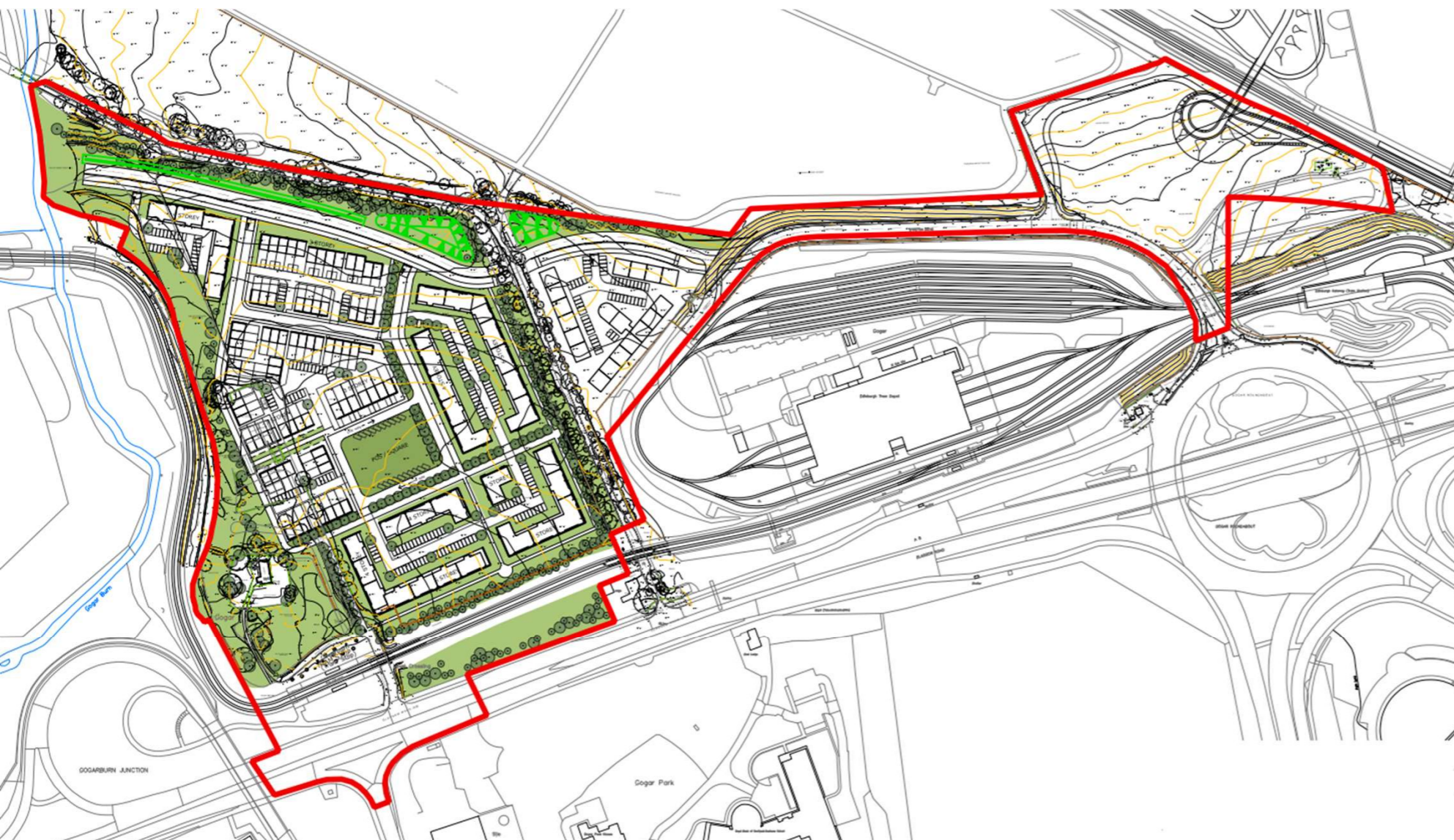

-  2 -3 STOREY HEIGHT
-  3 STOREY HEIGHT
-  4 STOREY HEIGHT
-  6 STOREY HEIGHT



-  BOULEVARD AND PUBLIC OPEN SPACE
-  BUILT FORM AND KEY FRONTAGE
-  OPEN SPACE AND INDICATIVE PLANTING

Your views are important to us, please remember to leave your feedback.